

## POINTS OF INTEREST

### Sacred Ground Map

- A. Original Shrine Location
  - B. Stations of the Cross & Pieta
  - C. Blessed Virgin Mary
  - D. Tower of Remembrance
  - E. St. Anthony
  - F. St. Frances Cabrini
  - G. Crucifixion
  - H. St. Anne and Mary
  - I. Our Lady of Fatima
  - J. Saint Joseph the Worker
  - K. Mission Cross
- Lower Level
- L. Gift Shop
  - M. Faith Room
  - N. Hope Room
  - O. Our Lady of Velankanni
  - P. Auditorium
  - Q. Pilgrim Chapel (under construction)  
\*Life of Saint Joseph Mosaic

- Upper Level
- R. St. Joseph Statue
  - S. Holy Family
  - T. Ambo
  - U. St. Joseph Icon
  - V. St. Joseph holding the Child Jesus
  - W. Tabernacle
  - X. Stations of the Cross
  - Y. Our Lady of Fatima
  - Z. Communion of Saints

## WELCOME

Since its establishment nearly 100 years ago by Fr. Thomas Augustine Judge, C.M. the founder of the Missionary Servants of the Most Holy Trinity, the Shrine of Saint Joseph has served as a tranquil, beautiful, and sacred place of welcome for thousands of pilgrims and visitors

and has become a vibrant, mission-centered spiritual home for many. You are most welcome to explore all the beauty the Shrine of Saint Joseph offers during your visit. The Main Chapel features floor-to-ceiling windows overlooking the beauty of God's creation with a view of the statue of St. Joseph holding the Child Jesus located on the veranda.

# Sacred Ground M A P

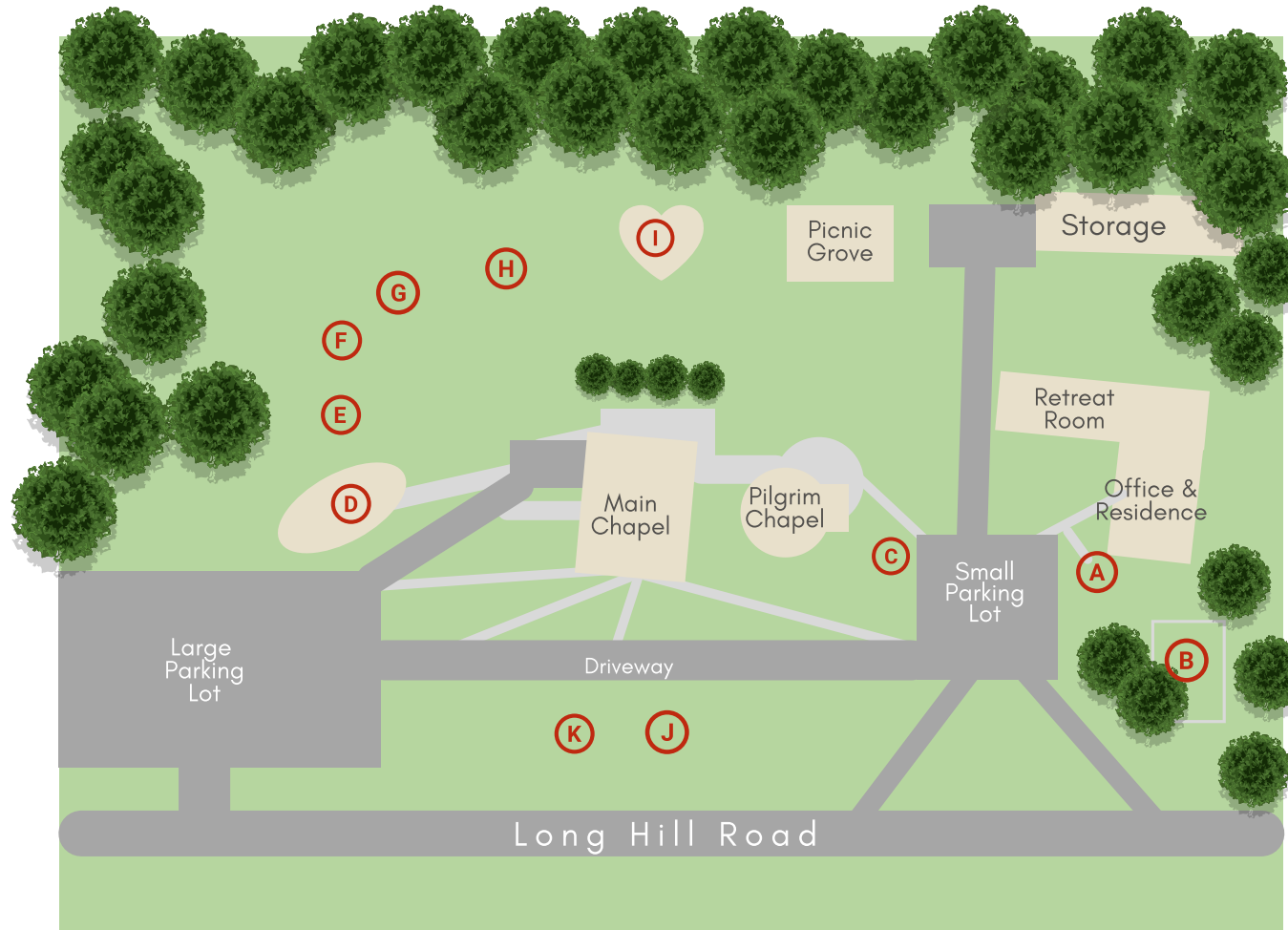

The interior of the Chapel features hand-carved pews, altar, ambo, tabernacle, and the Holy Family these features remind of the work of Saint Joseph as a carpenter and the dignity of work for all people. Just off the Chapel is the **Communion of Saints Hallway**. There you can light a candle for a special prayer request.

We are blessed to have a **Gift Shop** that is staffed by a wonderful group of Sisters that bring joy and peace to all that visit. The Shrine will soon be home to a beautiful and unique **Pilgrim Chapel** that will feature the exquisite nine by eight-foot **Life of St. Joseph** mosaic by Austrian artist Leopold Forstner and a wood reciprocal roof that draws one's heart toward heaven. The sacred grounds of the Shrine are located on 44 acres and offer many statues, grottos, and places for quiet reflection and prayer. Included are the Stations of the Cross & Pieta and the Path of Saints that include Saints Anthony and Frances Cabrini dedicated to immigrants, the Crucified Christ, Saint Anne with the Child Mary, and Our Lady of Fatima. Among its other moving features, the Shrine's **Tower of Remembrance**, composed of beams from New York City's World Trade Center, perpetually honors the victims of the 9/11 terrorist attacks and their families. On the front lawn **Saint Joseph the Worker** and the **Mission Cross** sits at the top of the hill overlooking the community as a symbol of welcome for all people.

Each day, the Shrine of St. Joseph welcomes individuals and groups of all backgrounds and cultures seeking to encounter the holy presence of God in serenity and peace. Its clergy, staff, and volunteers invite pilgrims and guests to experience God's presence and preserve and deepen their faith within the transcendent beauty of the Shrine of St. Joseph.

**The Shrine of St. Joseph: God's Presence, Your Peace.**



SCAN CODE TO SIGN UP!

## Main CHAPEL

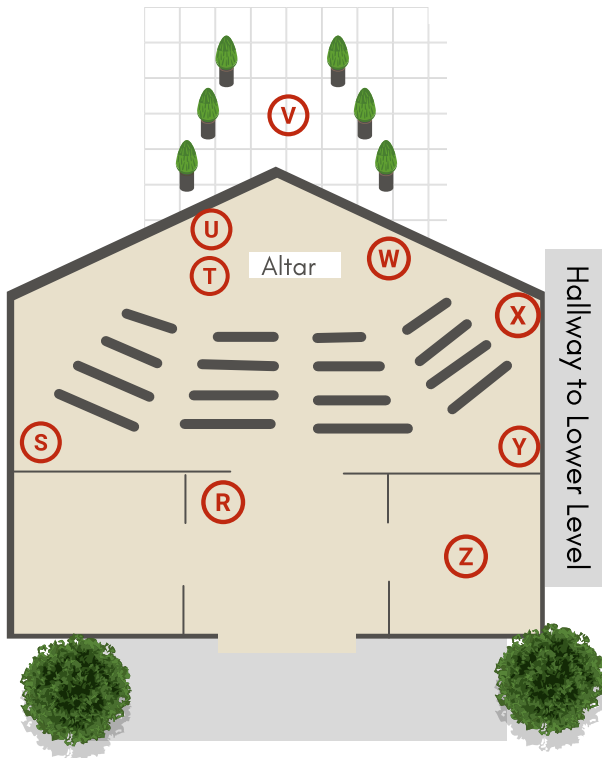

Hallway to Lower Level

### MASS AND SACRAMENTAL SCHEDULE

**Saturday**  
 5:30 pm - Vigil Mass - Chapel *English*  
 2nd, 4th, and 5th Sat.  
 Our Lady of Good Health - Chapel 1st Sat.  
 Santo Niño Filipino - Chapel on the 3rd Sat.

**Sunday**  
 8:00 am Chapel *English*  
 9:45 am Chapel (Emmaus Christian Community)  
 9:45 am Auditorium *Spanish*  
 11:45 am Chapel *Spanish*  
 6:00 pm Chapel 4th Sun. *Portuguese*

**Daily**  
 8:00 am Mon., Wed., Fri., Sat.- Chapel *English*  
 5:30 pm Tues., Wed. & Thurs. - Chapel *English*  
 7:00 pm Wed. - Chapel *Spanish*  
 12:00 noon Recovery Mass 2nd Sat. of the month

**Adoration of the Blessed Sacrament**  
 1:30-3:30 pm Mon., Tues., Thurs., Fri. - Chapel  
 9:00 am-5:00 pm Wed. - Chapel

**Confessions**  
 1:30-3:30 pm daily in Hope Room

**Devotion to Saint Joseph**  
 Sundays in the Chapel at 3:00 pm *English*  
 1st Sunday at 6:00 pm *Spanish*



Shrine of Saint Joseph  
 Missionary Servants of the Most Holy Trinity  
 1050 Long Hill Rd | Stirling, NJ 07980  
 shrineofsaintjoseph.com | 908.647.0208

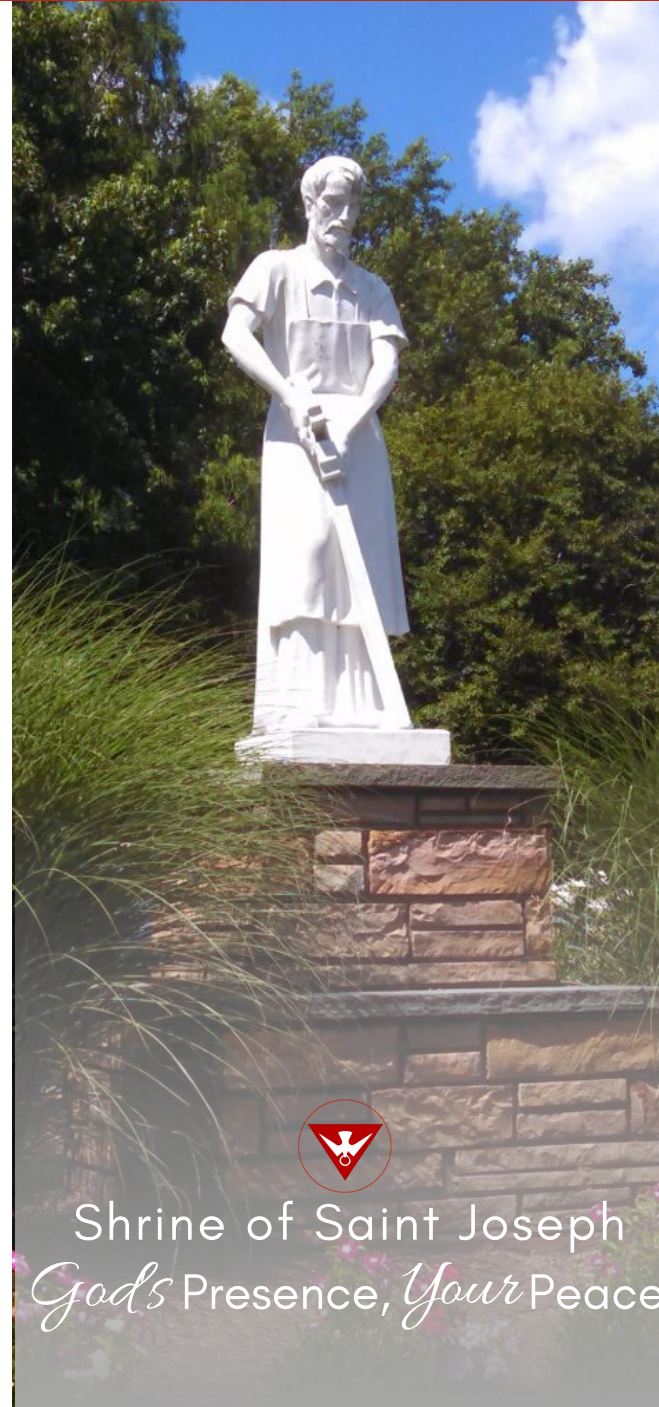

Shrine of Saint Joseph  
*God's Presence, Your Peace*

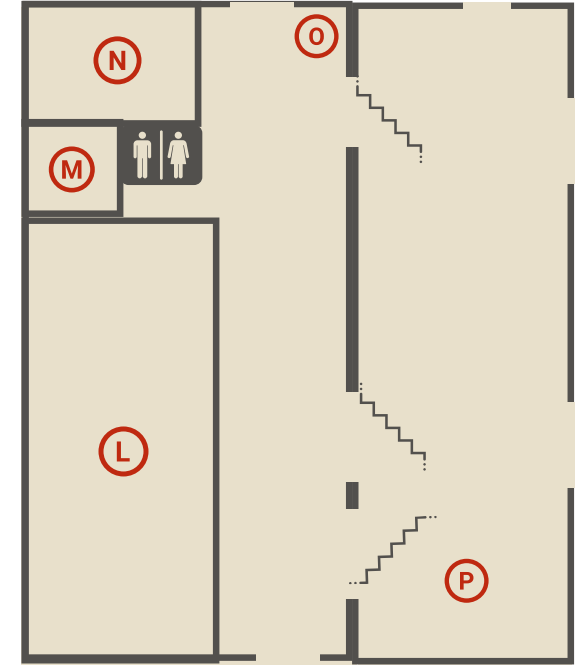

## Pilgrim CHAPEL

